



## MNK-I-N

Multi-jet wet dial meters for cold water Class C

The MNK is the tried and tested meter for domestic service connections.

Constant development guarantees accurate measuring results and the long-term stability. Special constructional details result in excellent running characteristics, a low bearing load and guarantees a long service life.

Pulse capable with the addition of a pulse module, which allows connection to an automation system or remote readout modules.

### PERFORMANCE CHARACTERISTICS

- Wet dial counter construction
- Viewing window made of high-quality uv proof plastic.
- For horizontal piping
- Pulse Unit (Reed switch) for remote readout systems, sold seperately.
- Standard 1 pulse per 100 litres



Zenner Code	Hydroflow Code	Size	Special Features
136385 MNK	WMZC15	15mm	Cold
136386 MNK	WMZC20	20mm	Cold
136387 MNK	WMZC25	25mm	Cold
136388 MNK	WMZC32	32mm	Cold
136449 MNK	WMZC40	40mm	Cold
136450 MNK	WMZC50	50mm	Cold Not pulse capable
111512	WMZMNK-N		Reed Switch/Pulse for MNK-N

TECHNICAL DATA MNK-I-N								
Nominal Diameter	DN		15mm	20mm	25mm	32mm	40mm	50mm
Nominal Flow	Qn	m <sup>3</sup> /h	1.5	2.5	3.5	6	10	15
Maximum Flow	Qmax	m <sup>3</sup> /h	3	5	7	12	20	30
Minimum Flow	Qmin	l/h	15	25	35	60	100	450
Transitional Flow	Qt	l/h	22.5	37.5	52.5	90	150	625
Starting Flow		l/h	4	5	5	10	20	25
Metrological class			C*H	C*H	C*H	C*H	C*H	C*H
			A*V	A*V	A*V	A*V	A*V	A*V
Display Range	min	l	0.05	0.05	0.05	0.05	0.05	0.05
	max	m <sup>3</sup>	99999	99999	99999	99999	99999	99999
Maximum Temperature		°C	30	30	30	30	30	30
Operating pressure, max.	PN	bar	16	16	16	16	16	16
Head loss at Qmax		bar	0.6	1	1	1	1	1
Pulse value		l/imp	10	100	100	100	100	Not pulse capable
Overall Length without conn.	L2	mm	165	190	260	260	300	300
Overall length with connectors.	L1	mm	250	288	378	378	438	438
Thread on meter	D1	mm	20	25	32	40	50	65
Thread on tail	D2	mm	15	20	25	32	40	50
Height	H1 k*	mm	120	115	140	140	-	-
	H1 m*	mm	125	120	145	145	170	190
	H2	mm	35	32	50	50	60	75
	H3	mm	15	15	15	15	15	15
Width	B	mm	95	95	100	100	131	165
Weight	H1 K*	kg	1.4	1.8	2.7	2.7	5.4	5.4

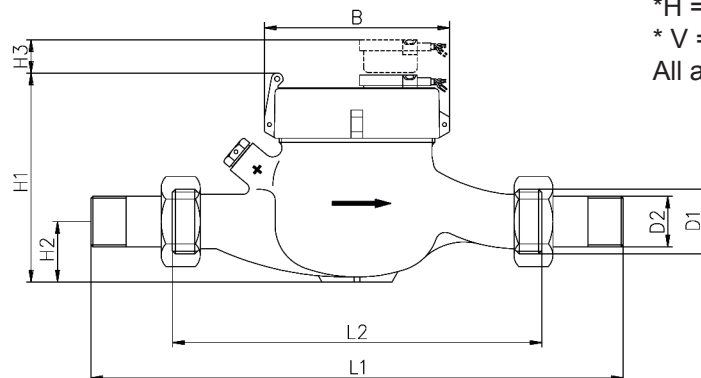

\*H = Horizontal

\*V = Vertical

All accuracies are listed as installed horizontal.

